

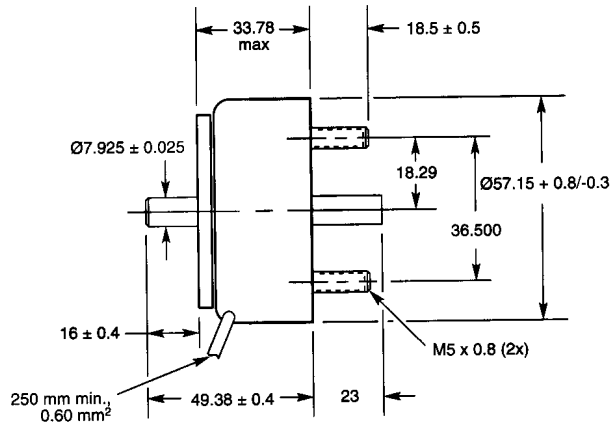

6ECM Low Profile Solenoids Push or Pull

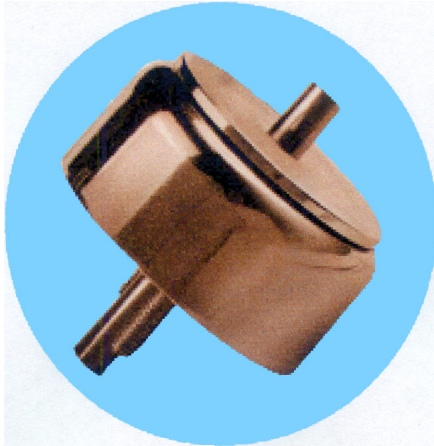

6ECM Medium Stroke, Conical Face
Part No. : 282352-0XX

Shown Energised

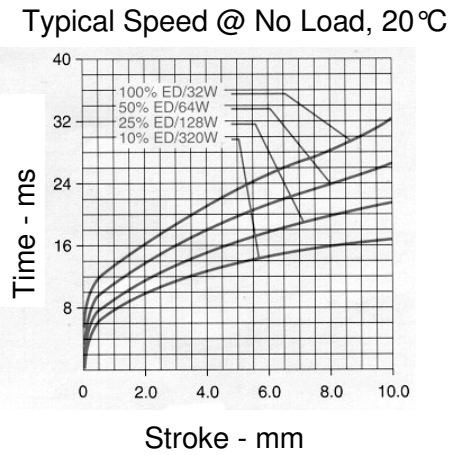
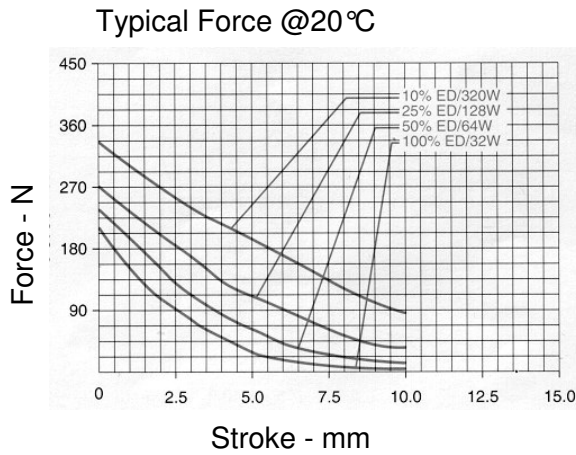

COIL DATA

Maximum Duty Cycle (%) = "On" Time / ("On Time" + "Off Time") X100%			Continuous	50%	25%	10%
MAX. "on" time in seconds			—	87	36	13
Watts at 20°C			32	64	128	320
Maximum ON Time (sec) for single pulse ²			—	140	44	16
Ampere-turns at 20°C			1480	2080	2940	4620
avg (0XX) ³	Resistance (20°C) Ω +10%	No.turns	Volts DC			
23	4.69	567	12.3	17.2	24.0	38.0
24	7.43	710	15.5	22.0	31.0	48.0
25	12.90	960	19.9	28.0	39.0	62.0
26	19.70	1170	25.0	35.0	49.0	78.0
27	32.00	1500	32.0	44.0	63.0	99.0
28	51.60	1904	40.0	56.0	79.0	125.0
29	74.40	2232	49.0	69.0	98.0	154.0

N.B. Other coil awg sizes available— Please consult factory